

UltraFlex IP65

Sealed Flexible LED Strip

Specifications & Installation

Guide



LED Lighting and Control
Designed and Manufactured in Australia

©2016 Digilin Australia.
Document Rev: 5.1 - 3 November 2016
Product specifications are subject to change without notice.

DIGILIN

Table Of Contents

Safety Notes	2
Specifications	3
Inputs	3
Optical.....	3
Dimensions	3
Strip	3
Mounting Clip	3
Installation	4
Precautions	4
Mounting	4
Wood and Plasterboard	4
Stainless Steel	4
Concrete	4
Wiring	5
Maintenance	5

Safety Notes

- Do not press on the LEDs when installing
- Do not over flex the strip
- Not intended for continuous immersion
- Installation should only be performed by a qualified professional
- Install in accordance with all appropriate wiring standards
- Never connect a LED fitting to a driver that is powered. Doing so may result in damage to the LED.
- Always make sure the output voltage range and output current of the LED driver match the requirements of the LED fitting. Failure to do so may result in damage both the driver and fitting.

Specifications

Inputs

			Units
Voltage	Nominal	24	VDC
	Min	23	
	Absolute Max	25	
Drive Current		200	mA/m
Watts		4.8	W/m
Maximum run from power connection		5	m

Optical

	White			Units
Order Code	W30	W41	W60	
Beam Angle	110			°
Colour Temp	3050	4100	6000	K
Typical Lumens	195	235	245	lm/m

Dimensions

All dimensions in mm

Strip

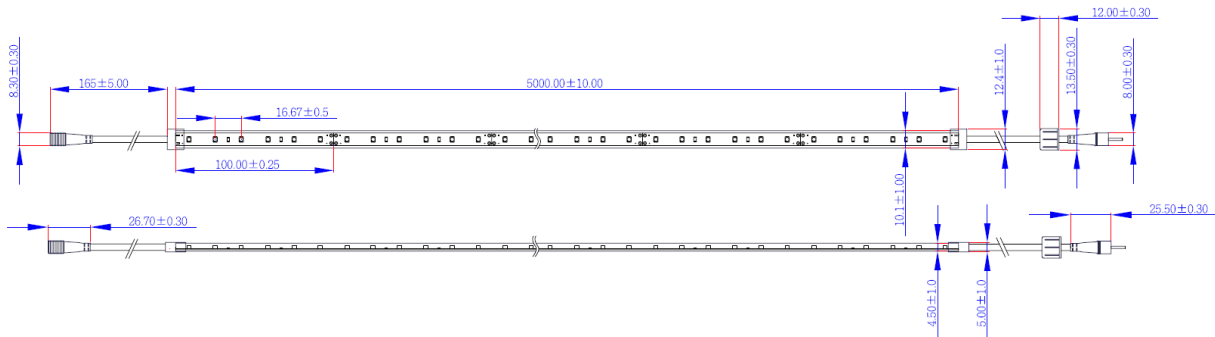

UltraFlex IP67 LED Strip is supplied in 5m Reels, LED spacing 16.54 mm.
 Cut to length strips shorter than 5m and maintaining IP rating, are available on request.

Mounting Clip

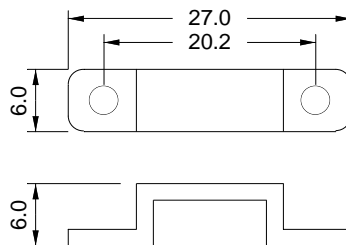

Installation

Precautions

- Strip is **not** rated for continuous immersion.
- Do not attempt to make sharp bends with the strip. Right angles should be achieved by cutting the strip and joining with wires.
- Over-flexing the strip may cause it to snap.
- **Do not** press on the LEDs when installing. Doing so may damage the LEDs.
- Do not install under mechanical stress
- Allow for expansion due to changes in temperature.
- Please be aware that while the system has a very long operational life, faults may still occur and provision needs to be made for maintenance.

Mounting

Wood and Plasterboard

- Screw the **mounting clip** in place over the LED strip.
Recommended Screw: M2.5 screws

or

Self tapping screws with a diameter of 2.2 to 2.9mm

Note: 1 clip for every 0.5m of strip required. Minimum of 2 clips.

11 clips required for every 5m reel

Stainless Steel

- Install temporary fixing in combination with **Selleys Roof and Gutter Translucent neutral cure, one-part silicone sealant**. Remove temporary fixing after sealant is dry.

Concrete

- Install **Digilin LLST shallow track** to concrete with temporary fixing and **Selleys Roof and Gutter Translucent neutral cure, one-part silicone sealant**. Remove temporary fixing after sealant is dry.
- Install LED strip to **Digilin LLST shallow track** with temporary fixing and **Selleys Roof and Gutter Translucent neutral cure, one-part silicone sealant**.
Remove temporary fixing after sealant is dry.
Note: **Digilin LLST shallow track** is used to provide a smooth surface for superior adhesion.

Wiring

- No continuous run of strips should exceed the specified maximum run value without additional power feeds.
 - LED Strip is supplied in 5m Reels and is to be connected to power driver at both ends for best performance, regardless of power driver used.
 - Only join strips powered by the same supply
1. With power off, push the mating connectors together



2. Firmly tighten the cap to achieve an IP67 seal.



3. Ensure that the other end of the strip is appropriately sealed or mated.

Maintenance

- Strips normally require no maintenance except for light cleaning
- Isolate from power before accessing
- Visually inspect strips at the time for any obvious faults
- The strips may be dusted with a non conductive brush. No fluids should be used
- If this procedure does not remove contaminants please contact Digilin for further advice.